

RPFL SuperDek® Colorbond® XRW/Ultra
0.42BMT/0.48BMT. Base Materials: Steel Grade G550.
BMT 0.42.Mass 4.3kg/m2 or 0.48BMT 4.9kg/m2. AZ 150
coating for XRW & AZ 200 coating for Ultra. Minimum Roof
Pitch 2 degree. Profiles tested for Cyclonic Conditions.

Flashguard Soft Edge flashing for metal roof accessories
Weather sealing membrane with elastic characteristics
compatible with zincalume, aluminium & galvanised steel
roof materials.

RPFL Colorbond® XRW/Ultra 0.55 BMT External
corner Flashing side lap fixed to cladding with rivets
@ 1000mm max. c/c between girts.

20mm thick cavity battens

Kingspan AIR-CELL Insulbreak
®65 R2.4 Self-Supported 3-in-1
Insulation Vapour Barrier and
Radiant Barrier

RPFL SuperDek® Colorbond® XRW/Ultra 0.42BMT/0.48BMT.
Base Materials: Steel Grade G550. BMT 0.42.Mass 4.3kg/m2 or
0.48BMT 4.9kg/m2. AZ 150 coating for XRW & AZ 200 coating
for Ultra. Minimum Roof Pitch 2 degree. Profiles tested for
Cyclonic Conditions.

BRA-TYPE 17 Self drilling assemblies for Timber.
Type 17 14-10x75 HEX Bra at every crest.

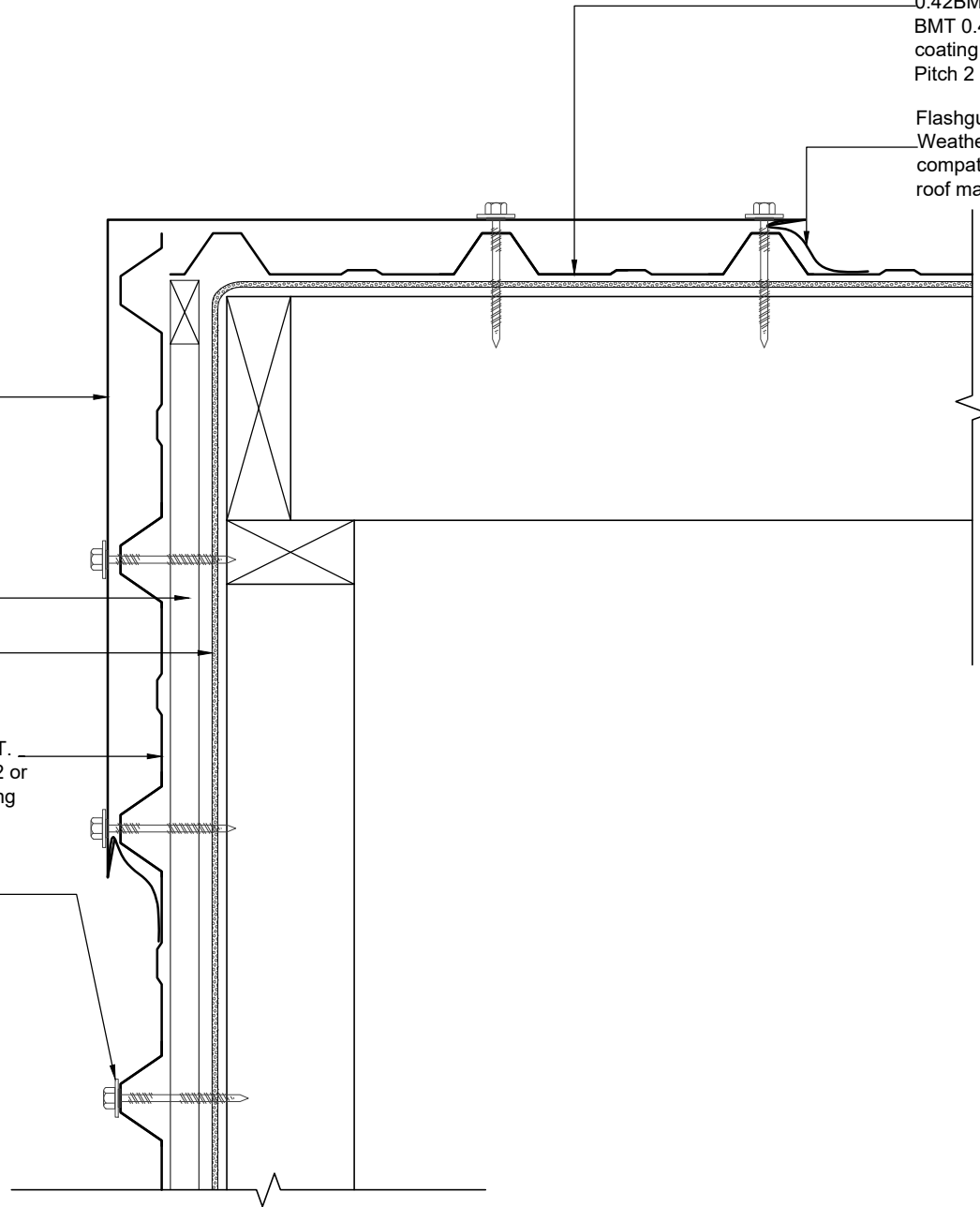

ROOFING & PROFILES (FIJI) LTD
PH: (679) 6673764. Mob: 9999 309
EMAIL: info@roofingandprofiles.com.fj

This drawing is the property of Roofing & Profiles (Fiji) Ltd and must not be copied or disclosed to any third party without the written consent of the company.
ALL DIMENSIONS ARE IN mm UNLESS STATED

PROJECT TITLE:
CORNER FLASHING DETAILS

DRAWING TITLE:
SHOP DRAWING

Nos:	Revision:		
1.			
2.			
3.			
4.			
5.			

DRAWN: R. Lal

DATE : 14/ 01 /2021

CHECKED BY: -

SCALE: 1:5 @ A4

REVISION No:

APPROVED BY: -

SHEET No : SD 2090

REVISION TITLE:

JOB NUMBER: