

RPFL SuperDek® Colorbond® XRW/Ultra
 0.42BMT/0.48BMT wall cladding. Base Materials: Steel
 Grade G550. BMT 0.42. Mass 4.3kg/m2 or 0.48BMT
 4.9kg/m2. AZ 150 coating for XRW & AZ 200 coating for
 Ultra. Minimum Roof Pitch 2 degree. Profiles tested for
 Cyclonic Conditions.

Kingspan AIR-CELL Insulbreak
 @65 R2.4 Self-Supported 3-in-1
 Insulation Vapour Barrier and
 Radiant Barrier

RPFL Std Colorbond® XRW/Ultra 0.55 BMT
 CAPPING. Base Materials: coating AZ150/AZ200
 Steel Grade G300. fixed with SDM Screw.

Top & Bottom Infill Strips/filler block or profiled foam
 fillers insert between cladding and flashing.

RPFL Zed & Cee sections are roll formed
 from GALVSTEEL, complying with
 AS1397-2001. Metal thickness is 1.5, 1.9 &
 2.4mm. BMT G450, Z450.

RPFL Zed & Cee sections are roll formed
 from GALVSTEEL, complying with
 AS1397-2001. Metal thickness is 1.5, 1.9 &
 2.4mm. BMT G450, Z450.

Support steel Structure

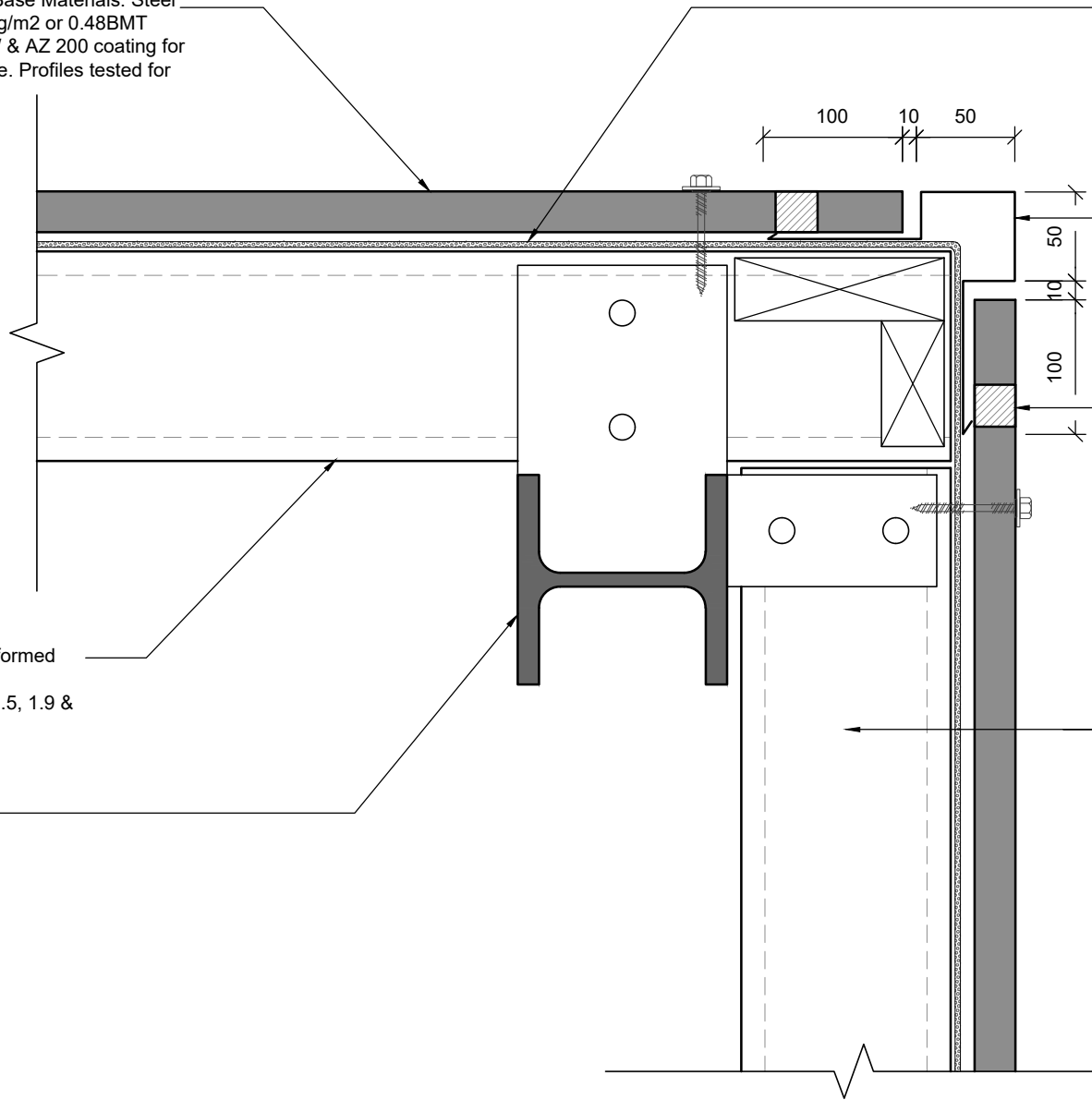

ROOFING & PROFILES (FIJI) LTD
 PH: (679) 6673764. Mob: 9999 309
 EMAIL: info@roofingandprofiles.com.fj

This drawing is the property of Roofing &
 Profiles (Fiji) Ltd and must not be copied
 or disclosed to any third party without the
 written consent of the company.
 ALL DIMENSIONS ARE IN mm UNLESS
 STATED

PROJECT TITLE:
 WALL DETAILS
 DRAWING TITLE:
 SHOP DRAWING

Nos:	Revision:		
1.			
2.			
3.			
4.			
5.			

DRAWN: R. Lal

SCALE: 1:5 @ A4

SHEET No : SD 2070

DATE : 16/ 01 /2021

REVISION No:

REVISION TITLE:

CHECKED BY: -

APPROVED BY: -

JOB NUMBER: